

Clear Height Sheds

Finally, a shed worth standing up for!



Includes
Detailed
Blueprints
and
Hardware

Aim High! Build With Us!

- Clear Height Gable Sheds in 3 available sizes
- Real 7-Foot High Walls for easier access
- Unique truss-wall design for simpler construction
- Double hinged door entrance
- Everything you need, including the hardware
- Siding, window and steel door options
- Top quality materials
- Expert advice

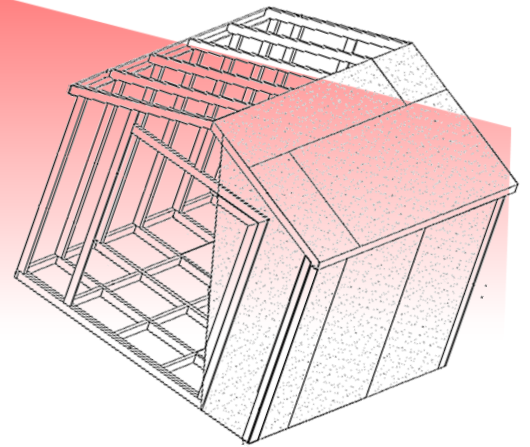

www.bytownlumber.com

Our Sheds Stand Up To You!

Build With Confidence with our Clear Height Sheds

Precise estimating and costing eliminates material errors

Complete Engineered Kit reduces on-site delays and mistakes

All-inclusive package, with no surprises, no missing components

Competitive pricing and products from reputable suppliers

Includes everything you need, right down to the hardware

Accurate delivery scheduling. On-time every time

Benefit from the support of Bytown's experienced construction specialists

Unique one-piece truss wall system simplifies construction

Real 7-Foot High Walls

Real double door or barn door

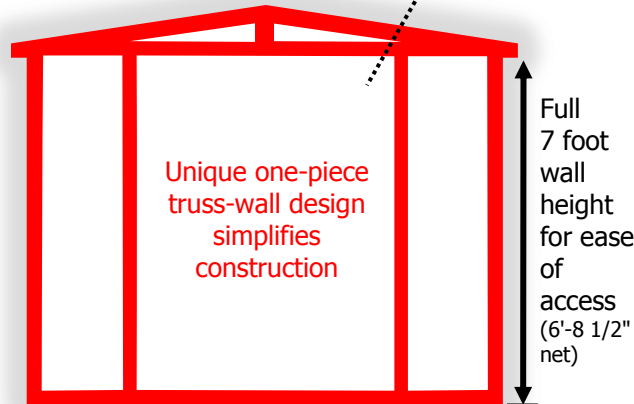

Your Package Includes:

- 1. Unique truss-wall system** combines floor, wall and trusses into a convenient module to simplify construction
- 2. Floor Sheathing**
5/8" OSB Floor Sheathing
Blocking and braces
- 3. Wall Sheathing**
7/16" OSB Sheathing
- 4. Finished Roof System**
7/16" OSB Roof Sheathing
25 Yr. Fibreglass Shingles
- 5. Doors**
Materials for Barn Doors
Door Hardware

Add These Popular Options

- 6. Exterior Finish**
Vinyl, wood or engineered
- 7. Steel Doors**
Double steel 32" doors
- 8. Windows**
Standard and PVC-shed windows available

Our gable sheds come in three sizes. Just pick the one that's right for you.

Width	Depth
10'	8'
10'	10'
10'	12'

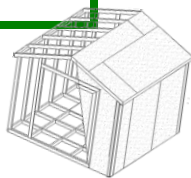

Build your shed with double-barn doors or choose optional double 32" steel doors



Choose from a wide variety of vinyl and wood siding options.



Ottawa
1740 Queensdale
T: (613) 733-9317
F: (613) 733-9267



Rockland
2678 Laurier
T: (613) 446-4772
F: (613) 446-4441



Limoges
2129 Calypso
T: (613) 443-1177
F: (613) 443-2644



Carleton Place
369 Town Line E.
T: (613) 253-1212
F: (613) 253-4994



Gatineau-Hull
921 St-Joseph
T: (819) 595-2772
F: (819) 595-0668



Aylmer
455 McConnell
T: (819) 684-9859
F: (819) 684-1902



Buckingham
700 Dollard
T: (819) 986-7155
F: (819) 986-7249



Papineauville
2761, Route 148
T: (819) 427-6264
F: (819) 427-8442



Maniwaki
462 St-Patrice
T: (819) 449-3840
F: (819) 449-3842